

## Kondensator AUDIO AUDIO Capacitor

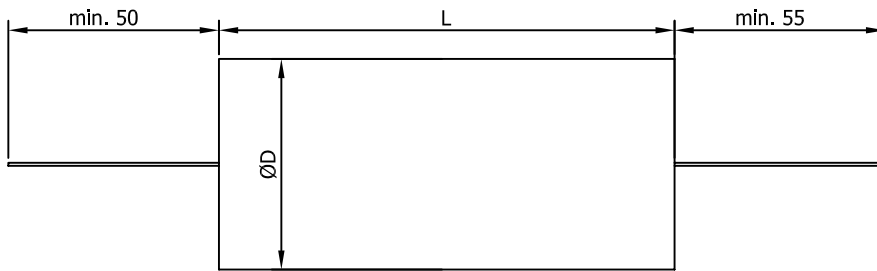

Dane Techniczne / Technical data:

Napięcie znamionowe Ur 600VDC  
Rated voltage

Tg kąta stratności <0,0050 @ 1kHz dla C≤1µF  
Disipation factor <0,0080 @ 1kHz dla C>1µF

Kategoria klimatyczna 025/085/21/C  
Climatic category

Wymiary zgodnie z tabelą  
Dimensions acc. to table

(Uwagi/Notes)

1. Wyrób spełnia wymagania Dyrektywy RoHS (2011/65/WE).  
This product fulfils the requirements of the RoHS Directive (2011/65/EC).

Pojemność znamionowa Rated capacitance	Tolerancja pojemności Capacitance tolerance	Wymiary / Dimensions	
		D+1	L+3/-2
µF	%	mm	mm
0,022	±5% / ±10%	13,8	31
0,027		15	
0,033		16,5	
0,039		17,5	
0,047		19	
0,056		20,5	
0,068		14,7	40
0,082		16	
0,1		17	
0,12		19	
0,15		21	
0,18		23	
0,22		25	
0,27		27,5	
0,33		30	
0,39	33	62	
0,47	35,5		
0,56	28,5		
0,68	31,5		
0,82	34		
1,0	37		

Istnieje możliwość uzgodnienia innych pojemności oraz długości i rodzaju wyprowadzeń.

Other capacitance values, lengths and types of leads are available at request upon prior agreement.

Description:

The KFPM-01 capacitors are distinguished by the use of electrodes made of copper foil, separated by polypropylene film. These capacitors are designed for use in audio equipment. The design of the capacitors minimizes the parasitic impedance components: inductance and resistance, resulting in improved quality of sound in a given audio system, where the positive effect is enhanced by the use of electrodes made of copper foil.

High quality and durability of the capacitors is assured by the use of carefully selected materials, production technology, as well as testing and measuring methods. These capacitors feature the use of axial terminals made of tinned copper wire, cover in the form of special protective tape, and self-extinguishing potting compound of flammability class V0.

The capacitors are furthermore subjected to a series of specific tests and measurements, including a unique test using pulses of increased current amplitude and frequency of 22kHz.

The KFPM-01 capacitors can be used in d.c. and a.c. circuits within the temperature range of their climatic category. The d.c. voltage value or a.c. voltage amplitude should not exceed the specified rated voltage.

PRZYKŁADOWY NADRUK  
PRINTING LAYOUT EXAMPLE

Oznakowanie  
okładziny zewnętrznej  
- krótsze  
wyprowadzenie /  
Marking of the outer  
electrode - shorter  
terminal

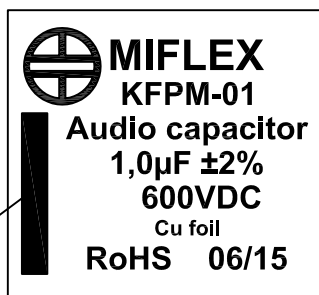

**MIFLEX S.A.**

ZAKŁADY PODZESPOŁÓW RADIOWYCH  
99-300 KUTNO, UL. GRUNWALDZKA 3 POLAND  
Chief Engineering Specialist +48 24 355 12 10  
Design Department +48 24 355 12 77  
Production Engineering Department +48 24 355 12 77  
Fax +48 24 355 12 88  
E-mail miflexsa@miflex.com.pl

Strona/  
Page

1/1

Data aktualizacji/  
Revision date

04.07.2016.